

Data Sheet

NP

Hand Nail Plate

A cost effective method of jointing structural timbers (such as site built trusses) simply by nailing through the pre-punched holes. Plates must be fixed on both sides of the timber. Manufactured from galvanised steel to BS EN 10346:2009 + G275.

The pressed dimple design adds strength and rigidity to the component whilst also assisting in the location of nails. Fix using BPC Sheradised Square Twisted Nails 30x3.75mm.

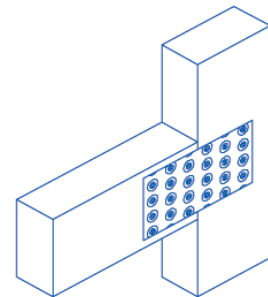
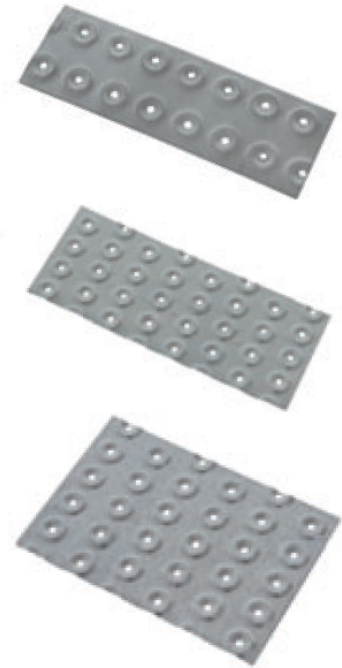

Non-standard sizes are available to order.

Product Reference	Size	Box Qty.
NP/50x150	50x150mm	250
NP/80x150	80x150mm	250
NP/80x200	80x200mm	200
NP/80x250	80x250mm	100
NP/80x300	80x300mm	100
NP/80x350	80x350mm	100
NP/80x400	80x400mm	100
NP/100x150	100x150mm	250
NP/100x200	100x200mm	100
NP/100x250	100x250mm	100
NP/100x300	100x300mm	100
NP/100x350	100x350mm	100
NP/100x400	100x400mm	100
NP/150x200	150x200mm	100
NP/150x250	150x250mm	100
NP/150x300	150x300mm	100
NP/150x350	150x350mm	100
NP/150x400	150x400mm	50
NP/200x200	200x200mm	25
NP/200x250	200x250mm	25
NP/200x300	200x300mm	25
NP/200x350	200x350mm	25
NP/200x400	200x400mm	25



To order or find out more
call **01924 364 794**
or scan the QR code.

WIDTHS	STANDARD LENGTHS						
	50	150	200	250	300	350	400
80		24	32	40	48	56	64
100		30	40	50	60	70	80
150	15		60	75	90	105	120
200			80	100	120	140	160

NO OF HOLES PER COMPONENT

**HOLES 4mm DIA
INDENTS 14mm DIA**

FIXING DETAILS
USE SHERADISED SQUARE TWIST
32x3.75mm DIA NAILS IN ALL PRE
PUNCHED HOLES TO ACHIEVE THE
RECOMMENDED SWL

**MANUFACTURED FROM .9mm PRE GALVANISED STEEL TO
BS EN 10346 (2009) DX51D (G275)**

BPC Building Products Ltd, Flanshaw Way, Wakefield

MATL .9mm PRE GALV MILD STEEL	UNSPEC TOLS	DIMS mm	SCALE	DRAWN MJS DATE 1/2/11	CHECKED DATE
DESCRIPTION NAIL PLATE		PRODUCT CODE NP		DRAWING NO 041	